

Proposed Project at Mouza-Taljuli, J.L. No-239, L.R. Khatian No-1320, 1321, 1322, 1310, L.R. Plot No-780, Ward No-28, under Kharagpur Municipality, P.S.- Kharagpur, P.O.-Kharagpur, District-Paschim Medinipur

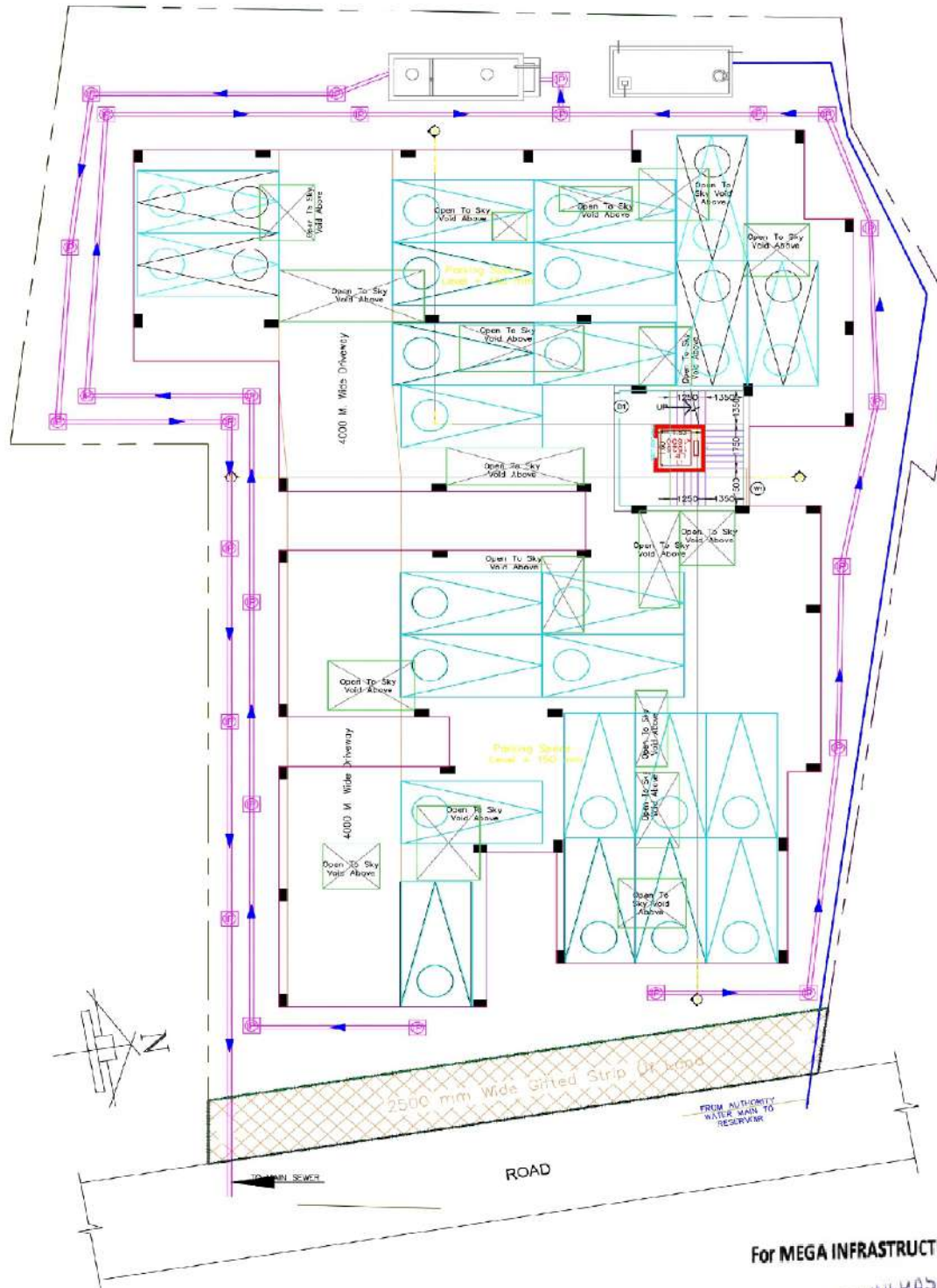

LATITUDE : 22.361880
LONGITUDE : 87.475671

FOR MEGA INFRASTRUCTURE
MEGA INFRASTRUCTURE
M. Daisy Nath
PROPRIETOR Proprietor

SIGNATURE OF OWNER